

ING.-BÜRO WLH. MUTTER
VORM. PROF. DR. SCHMITT
7500 K'HE-DURLACH
HILDEBRANDSTR. 38 • TEL. 15513







Handwritten notes and signatures in the bottom right corner, including the name "S E Z E N I" and various numbers like 284.77, 6993.77, and 6991.

GEMEINDE KIPPENHEIM

DECKBLATT ZUM BEBAUUNGSPLAN

» SELZEN I «

ZEICHENERKLÄRUNG:

-  Straßenbegrenzungslinie § 9 Abs. 1 Nr. 11 BBauG
-  Baugrenze § 23 Abs. 2 Bau NVO
-  Straßenverkehrsfläche § 9 Abs. 1 Nr. 11 BBauG
-  Grenze des räuml. Geltungsbereichs des Bebauungsplanes § 9 Abs. 7 BBauG
-  Sichtfläche, max. Pflanzhöhe 0,80m § 9 Abs. 1 Nr. 11 BBauG
-  Gebäudehaupttrichtung § 9 Abs. 1 Nr. 2 BBauG
-  offene Bauweise § 22 Abs. 2 Bau NVO

Baugebiet	Zahl d. Vollgeschosse
Grundflächenzahl	Geschossflächenzahl
Bauweise	Dachneigung

Dachform

M. 1 : 1 000

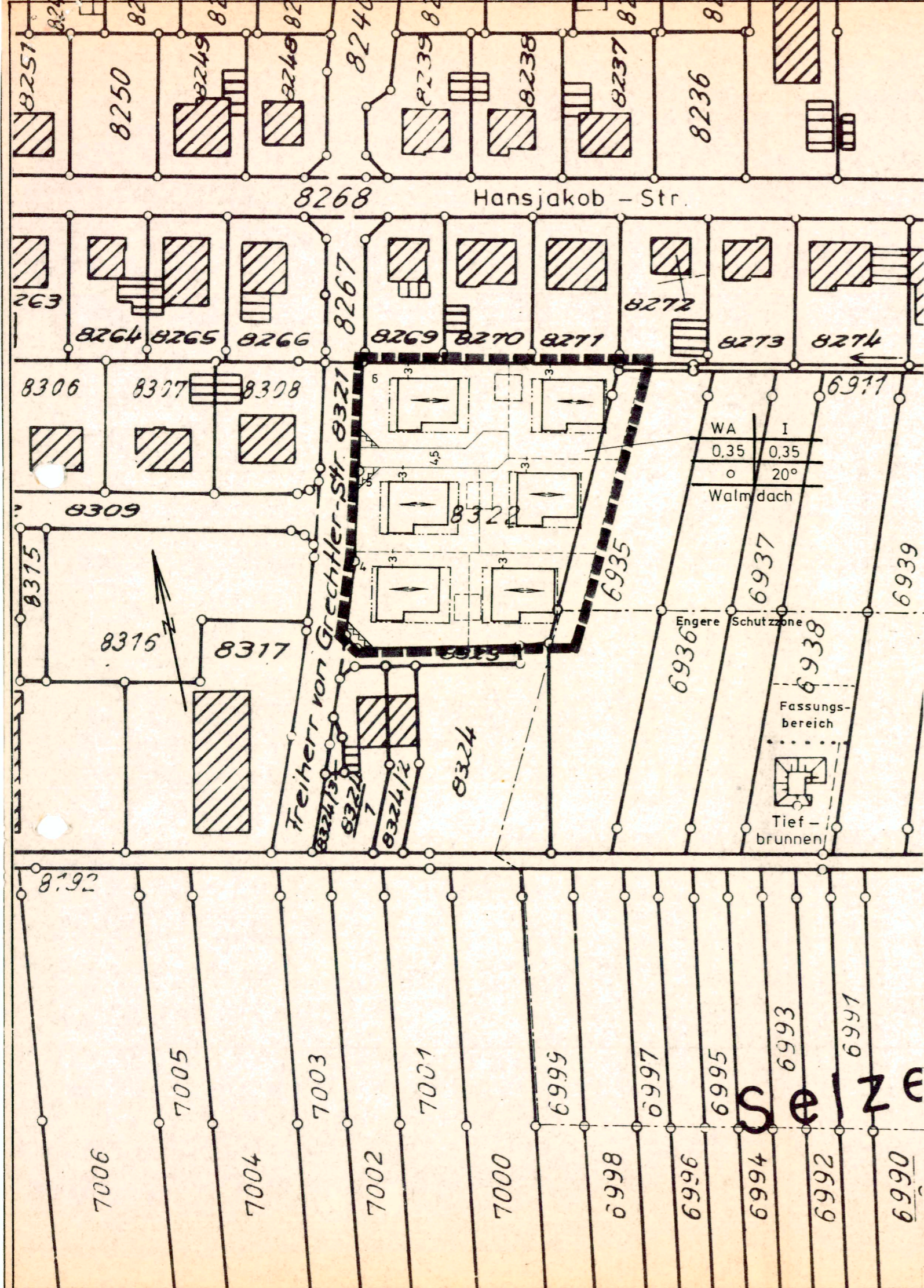

WA	I
0,35	0,35
o 20°	
Waldach	

SELZEN